

You have decided to buy a watch, which was assembled by a watchmaker using a Ronda movement. Please note that no watches are produced or distributed under the Ronda brand.

**In case of repairs, guarantee claims and questions concerning the functioning of a watch, purchasers and consumers should contact their retailer or the watch manufacturer, for which the relevant information can be found in the sales or guarantee documentation provided with the watch.**

**Description of the display and control buttons**

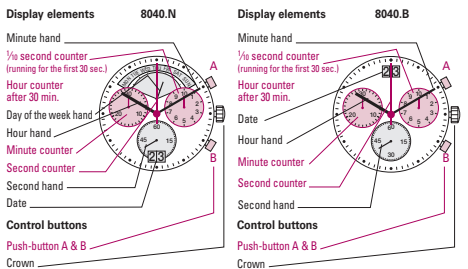

01

**Chronograph: Basic function**

(Start / Stop / Reset)

Example:

- 1 **Start:** Press push-button A.
- 2 **Stop:** to stop the timing, press push-button A once more and read the chronograph counters: **4 min / 38 sec / 7/8 sec**
- 3 **Zero positioning:** Press push-button B. (The chronograph hands will be reset to their zero positions.)

05

**Chronograph: Accumulated timing**

Example:

- 1 **Start:** (start timing)
- 2 **Stop:** (e.g. 15 min 5 sec following 1)
- 3 **Restart:** (timing is resumed)
- 4 **Stop:** (e.g. 5 min 12 sec following 3) = **20 min 17 sec** (The accumulated measured time is shown)
- 5 **Reset:** The chronograph hands are returned to their zero positions.

**Please note:**  
\* Following 4, the accumulation of the timing can be continued by pressing push-button A (Restart / Stop, Restart / Stop, ...).

06

**Setting the time**

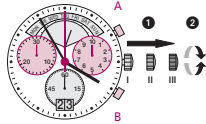

- 1\* Pull out the crown to position III (the watch stops).
- 2 Turn the crown until you reach the correct time 8:45.
- 3\* Push the crown back into position I.

**Please note:**  
\* In order to set the time to the exact second, 1 must be pulled out when the second hand is in position «60». Once the hour and minute hands have been set, 3 must be pushed back into position I at the exact second.

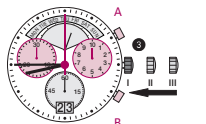

02

**Chronograph: Intermediate or interval timing**

Example:

- 1 **Start:** (start timing)
- 2 **Display interval:** e.g. 20 minutes 17 seconds (timing continues in the background)
- 3 **Making up the measured time:** (the chronograph hands are quickly advanced to the ongoing measured time.)
- 4 **Stop:** (Final time is displayed)
- 5 **Reset:** The chronograph hands are returned to their zero position.

**Please note:**  
\* Following 2, further intervals or intermediates can be displayed by pressing push-button B (display interval / make up measured time, ...).

07

**Setting the date (quick mode)**

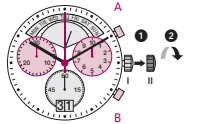

- 1 Pull out the crown to position II (the watch continues to run).
- 2 Turn the crown anticlockwise until the correct date 01 appears.
- 3 Push the crown back into position I.

**Please note:**  
During the date changing phase between approx. 8 PM and 12 PM, the date must be set to the date of the following day.  
An extreme acceleration in setting the date with quick mode can induce a false date indication. The synchronization is re-established by setting the date from 01 till 31 (crown in position II).

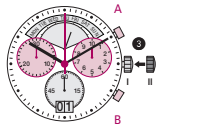

03

**Adjusting the chronograph hands to zero position**

Example:

One or several chronograph hands are not in their correct zero positions and have to be adjusted (e.g. following a battery change).

- 1 Pull out the crown to position III (all chronograph hands are in their correct or incorrect zero position.)
- 2 Keep push-buttons A and B depressed simultaneously for at least 2 seconds (the second counter hand rotates by 360° → corrective mode is activated.)

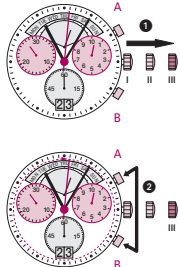

08

**Setting the date, day of the week (8040.N), time**

Example:  
- Date / time on the watch: 17 / 01:25 / MON  
- Present date / time: 23 / 20:35 / SAT

- 1 Pull out the crown to position III (the watch stops).
- 2 Turn the crown until yesterday's day of the week FRI appears.
- 3 Push the crown to position II.
- 4 Turn the crown anticlockwise until yesterday's date appears 22.
- 5\* Pull out the crown to position III (the watch stops).
- 6 Turn the crown until the correct date 23 and day of the week SAT appears.
- 7\*\* Continue to turn the crown until the correct time 8:35 PM appears.
- 8 Push the crown back into position I.

**Please note:**  
\* To set your watch to the exact second, please refer to the chapter entitled «setting the time».  
\*\* Please observe the AM/PM clock rhythm.

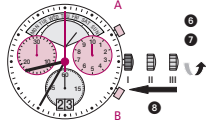
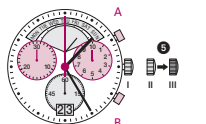
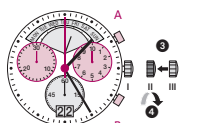
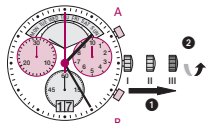

04

**Adjusting the second counter hand**

Single step 1 x short  
Continuous long

**Adjusting the next hand B**

**Adjusting the 1/2 second counter hand (position 3h)**

Single step 1 x short  
Continuous long

**Adjusting the next hand B**

**Adjusting the minute counter hand (position 9h)**

Single step 1 x short  
Continuous long

- 3 Returning the crown to position I  
Termination of the chronograph hands adjustment (can be carried out at any time).



Battery type: 395 / SR927SW  
Accuracy: +20 / -10 seconds per month

